

**RIGHT SIDE VIEW**

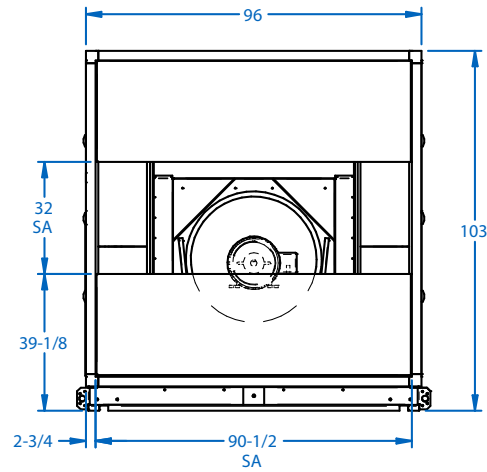
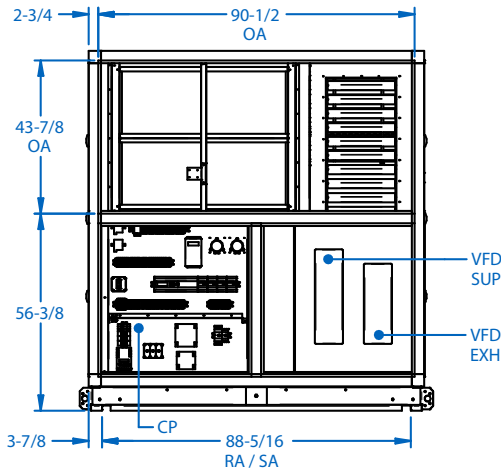

**UNIT DESIGN CONDITIONS AND CAPACITIES**

Nominal Air Flow (SA) CFM @ 1.5"ESP	20,000
Cabinet SA Range, CFM	12,000-21,000
Max Outdoor Airflow (OA) CFM	20,000
Typ.* Moisture Removal, lb/hr @ Max OA	360
Unit Weight, lbs	8,000
Typ.* Max Aux Hot Water Cap., MBH	869
Heat Pipe (HP), Max Size	D
HP Min Airflow, CFM	2,800
HP Max Airflow, CFM	7,000
HP Typ.* Capacity, MBH	300

\*Typical (Typ.) capacities as determined at 84°F, 60%RH space, 2°F OAT, 60°F OA dpt with largest standard components

VOLTAGE	208-230/3PH	460/3PH	575/3PH
MCA	130	66	48
MOP	160	82	59

@Nom SA, 60% OA

**STANDARD FEATURES:**

- SuperVisaire® Control System
- Remote Wireless Factory Monitoring
- Direct-drive Plenum Fans
- Vertical Heat Pipe
- 2" Double Walled Cabinet
- Active Airflow Control
- Exhaust Fan Purge/Economizer

**OPTIONAL FEATURES SHOWN**

- Hot Water Coil
- Indoor Configuration

**AVAILABLE OPTIONS**

- BACnet IP or MS/TP Interface
- Outdoor Cabinet Design
- Gas or Hot Water Auxiliary Heating
- Chilled Water Coil Auxiliary Cooling
- Higher or Lower Airflows or Static Pressures
- Unit Mounted Disconnect